

## Dosing Glas 1.500ml; with continuous level measurement

- sterile, non-contact but in-situ

table-top device in stainless steel with exchangeable jar in borosilicate glas, including immersion tube (autoclavable) and continuous feed control, as a compact system, including

# (pneu.) hose pinch valve      # level probe      # and Control-Unit (LCD)

regulate the INLET of the liquid

**ESV 14-16mm**

hose-pinch-valve; made in stainless steel

hose (DN8/10) 65° Shore; 14-16mm

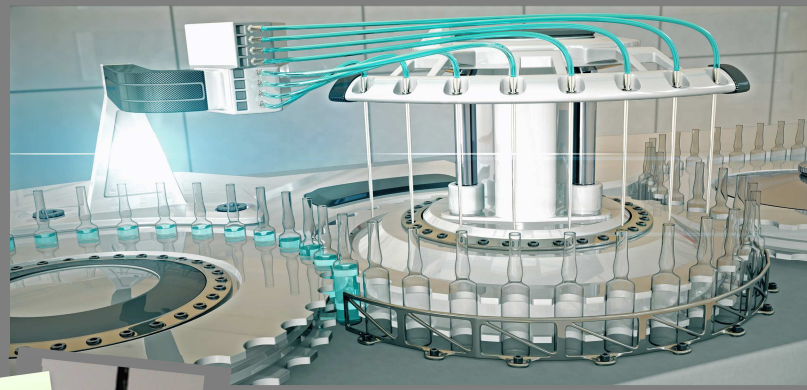
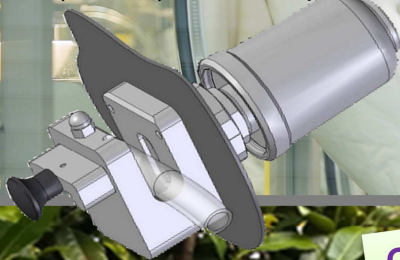

**Calibrate in Seconds**  
 „...with two actions!“

The Synva dispensing instrument tool Dplus 1500 is used for continuous, pressure-free extraction of a liquid product.

**“Set up - level probe in and it runs!”**

Your downstream dosing or filling system is supplemented almost independently. So don't plan your PLC control again!

**Level probe with no contact to the liquid**

Measuring: RF-capacitive 0,04 - 3.000pF

(deviation: max.0,2% from final value)

**NOW....SYNVA Dplus 1500-66-DOUBLE Vessel with 66-Liters Up to 6,0bar and two ESV's**

**It's NEW!**



Dispensing instrument tool according to the Machinery Directive 2006 / 42/EG; CE

Borosilicate glas stoch jar; 1500ml, DIN 3585 – incl. Immersion tube; level probe, hose pinch valve; Pressure Equipment Directive 2014 / 68 /EU



# synva Dosing-Stock-Instrument Dplus 1500

Dosing Glas 1.500ml; with **continius level measurement**

- **sterile**, non-contact but **in-situ**

## Continius level measurement

- with Key-Pad und Control-Unit;
- as an limit control

to control the inlet of a liquid about a pinch valve; incl.

- alarm signal, e.g. to check
  - missing Medium
  - „smaller-low-activity“; 0-600 seconds
  - connection Level probe / Control-Unit



**It's NEW; Vessel with 66 Liters (6,0bar)**



### Stock jar 1500ml :

-40°C bis + 500°C; Glas made in **Borosilicate**, DIN 3585;  
Cleaning : CIP / SIP - autoclavable

### Tube pinch valve: Pressure Equipment Directive 2014 / 68 EU

in stainless steel 1.4408, -15°C to + 55°C;  
Pressure : 0,0bar to 6,0bar  
Function : pressureless closed; „with compression spring“  
for inserting and squeezing a hose DN 10, max. 65°Shore  
with an outer diameter from 14mm up to 16mm



## Synva Dosing-Stock-Instrument Dplus 1500 ;

Complete made in stainless steel 1.4301; machinery directive 2006/42/EG  
Table top device; ca. 240mm x 160mm x 300mm, incl. Mast and holder for the glas  
Including elements of following functions

**Elec. connection:** 230 Volt 50Hz Options: 12 / 24 Volt DC

**Measuring:** RF-capacitive ( 0 – 3000pF; deviations 0,2%)

- **Options:** MODBUS RS 485 – communication  
Output signal 4 -20mA

Level probe made in stainless steel (1.4404) and Teflon : -60 °C up to + 200°C  
Control Unit and Keypad : -20 °C up to + 55°C